

## FEMALE STRAIGHT ADAPTER

Thread BSP Parallel

Type: **3012..**

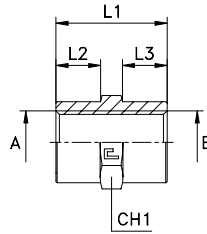

Series BS	30.... [bar]	31.... [bar]	Ordering Complete	A	B	L1	L2	L3	CH1
UNIVERSAL	350	350	301201	1/8	1/8	20	7	7	14
			301202	1/4	1/4	30	12	12	19
	250	250	301203	3/8	3/8	30	12	12	24
			301204	1/2	1/2	38	15	15	27
	200	200	301205	3/4	3/4	40	15	15	36
	160	160	301206	1	1	48	19	19	41
			301207	1 1/4	1 1/4	50	19	19	55
			301208	1 1/2	1 1/2	50	18	18	60
	350	350	301209	1/8	1/4	25	7	12	19
	250	250	301210	1/8	3/8	25	7	12	24
			301211	1/4	3/8	30	12	12	24
	225	225	301212	1/4	1/2	35	12	15	27
	200	200	301213	1/4	3/4	37	12	15	36
	225	225	301214	3/8	1/2	35	12	15	27
	200	200	301215	1/2	3/4	40	15	15	36

**Notes:** If you wish to order a fitting in stainless steel, please change the first two digit from **30....** to **31....** .

## FEMALE STRAIGHT ADAPTER

Thread Metric Parallel

Type: **3013..**

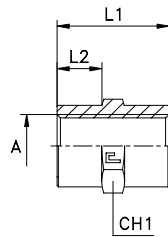

Series BS	30.... [bar]	31.... [bar]	Ordering Complete	A	L1	L2	CH1
UNIVERSAL	350	350	301301	10x1	20	7	14
			301302	14x1,5	30	12	19
	250	250	301303	16x1,5	30	12	24
	225	225	301304	22x1,5	38	15	27
	200	200	301305	27x2	40	15	36
			301306	33x2	48	19	41
			301307	42x2	50	19	55
			301308	48x2	50	18	60

**Notes:** If you wish to order a fitting in stainless steel, please change the first two digit from **30....** to **31....** .  
Articles available on scheduled orders only.